



# **Wireless Local Area Network Configuration Guide For Windows 11 (CPCE\_Staff)**

**College of Professional and Continuing Education  
The Hong Kong Polytechnic University**

**Version 1.0**

HELPDESK	Location	Tel no.
For HHB	Room UG10	3746-0818
For WK	Room S203/204	3746-0819

Email: [pfitoper@cpce-polyu.edu.hk](mailto:pfitoper@cpce-polyu.edu.hk)

---



1. Click the “**Network**” icon on the taskbar

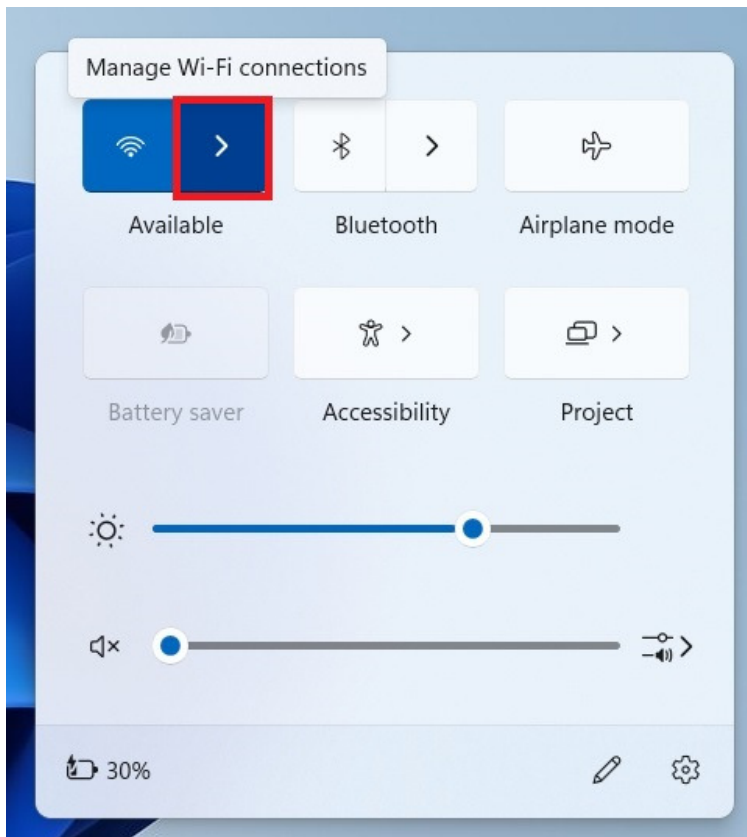

2. Click the **right arrow** icon on the Wi-Fi options to show the list of available Wi-Fi networks

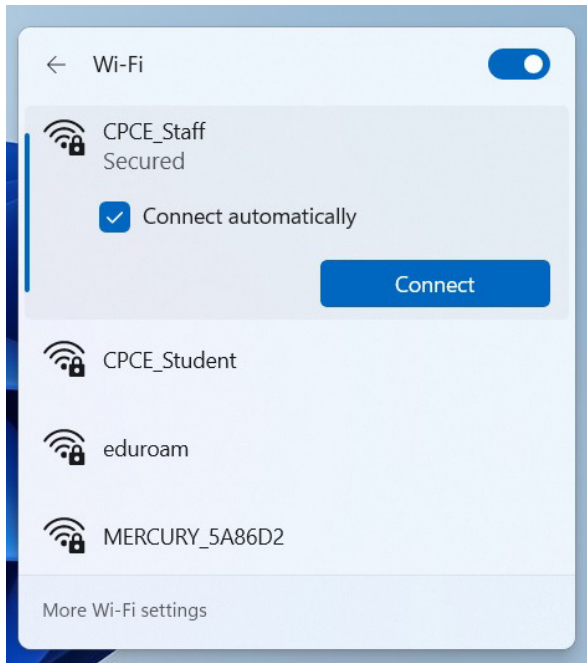

- 3.1. Select “**CPCE\_Staff**” and check “**Connect automatically**”
- 3.2. Click “**Connect**”

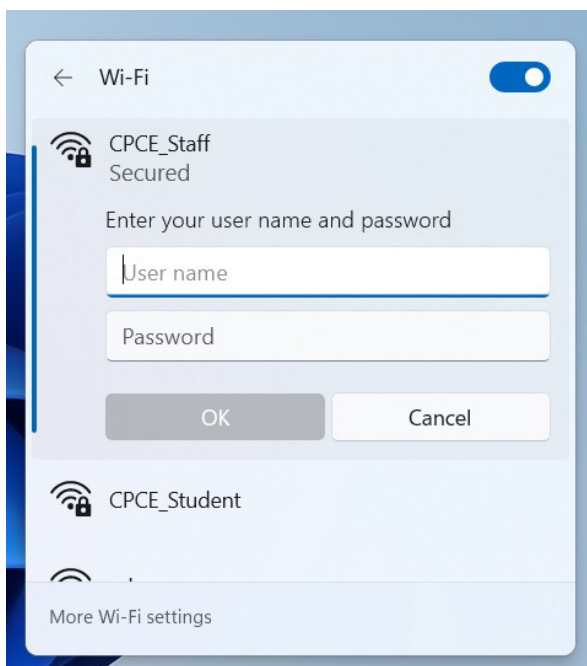

4. Enter your account information (**userID & Password**) and select “**OK**”  
The information should be same as the one for college portal

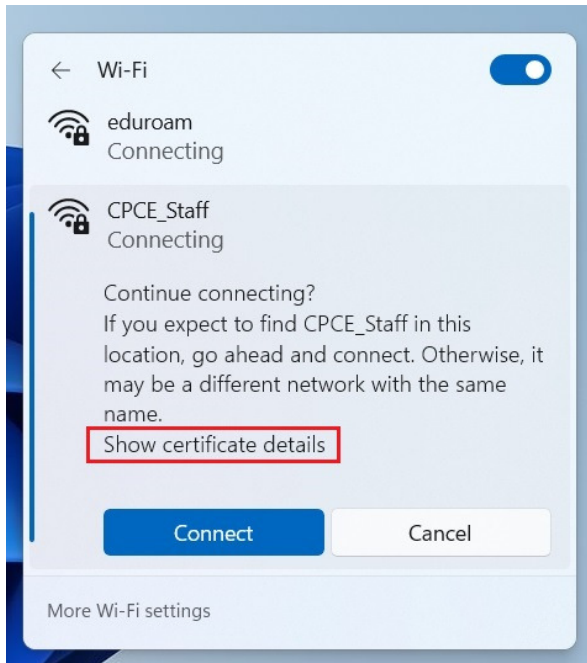

5. Click “**Show certificate details**” to expand more information

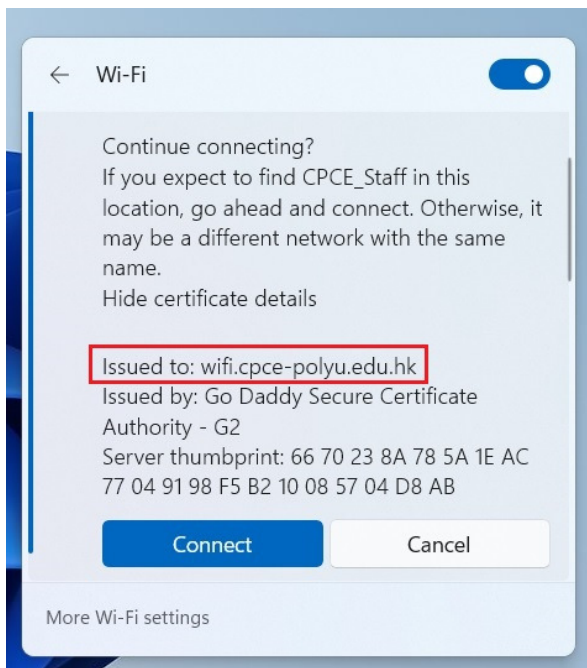

6.1. Verify that if the **certificate** is issued to **wifi.cpce-polyu.edu.hk**

6.2. Click “**Connect**” only if correct certificate details are shown

--- End ---