



Wireless Local Area Network Configuration Guide For Windows 11 (eduroam)

**College of Professional and Continuing Education
The Hong Kong Polytechnic University**

Version 1.0

HELPDESK	Location	Tel no.
For HHB	Room UG10	3746-0818
For WK	Room S203/204	3746-0819

Email: pfitoper@cpce-polyu.edu.hk



1. Click the “**Network**” icon on the taskbar

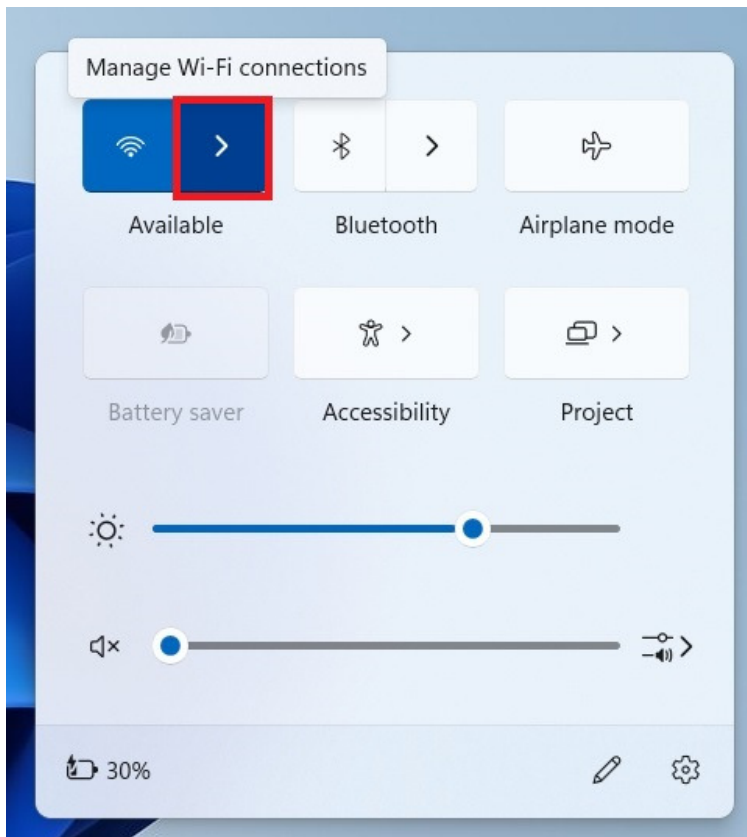

2. Click the **right arrow** icon on the Wi-Fi options to show the list of available Wi-Fi networks

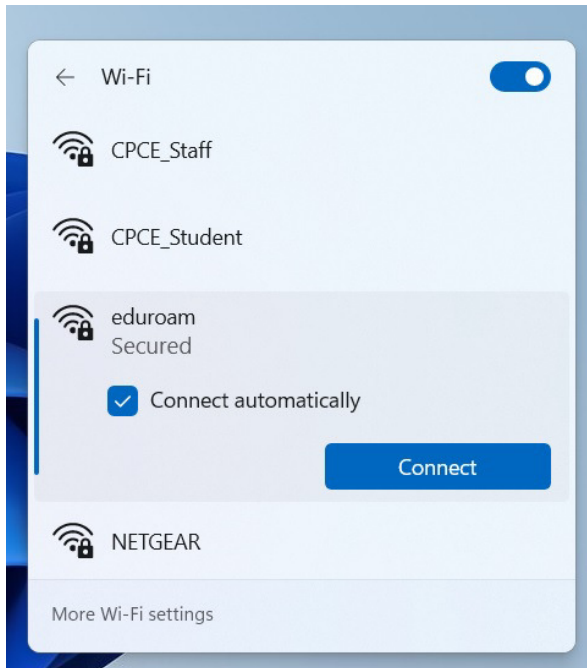

- 3.1. Select “**eduroam**” and check “**Connect automatically**”
- 3.2. Click “**Connect**”

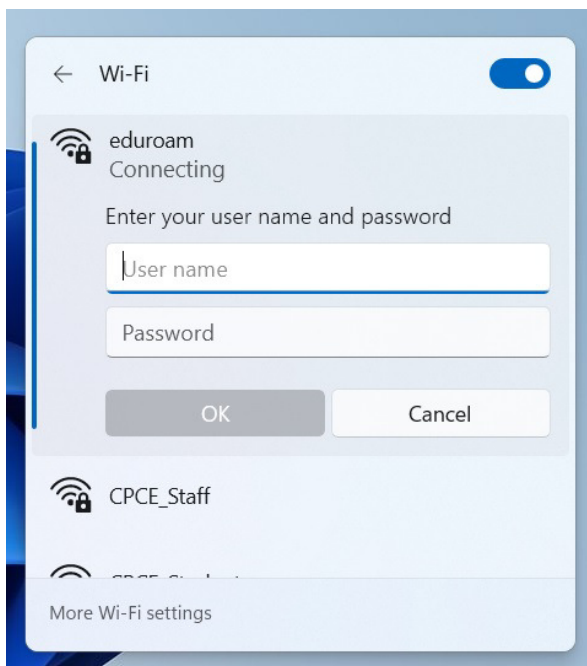

4. Enter your account information (**studentID@cpe.hk** & **Password**) and select “**Join**”
User must enter **@cpe.hk** after your **studentID** in the user name field
studentID should be same as the one for college portal

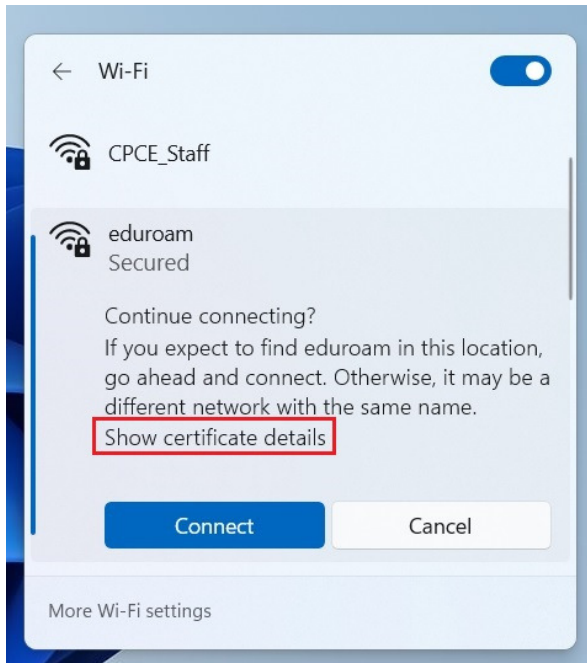

5. Click “**Show certificate details**” to expand more information

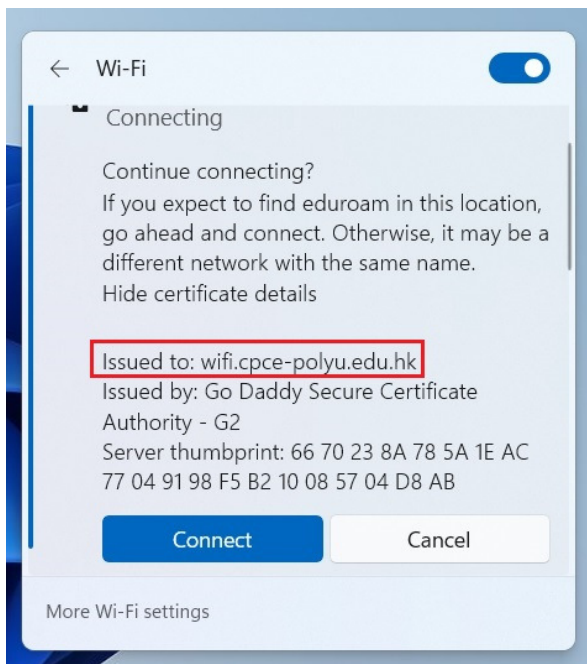

6.1. Verify that if the **certificate** is issued to
wifi.cpce-polyu.edu.hk

6.2. Click “**Connect**” only if correct certificate details are shown

--- **End** ---